

REDUCING BUSH

Fittings with GAS threading

Fittings



MODEL CODE: 0400234

TECHNICAL DATA SHEET

Connectivity standard:	External thread GAS cylindrical ISO 228/1 Internal thread GAS cylindrical ISO 228/1. Bucchi srl for pipe fittings adopts as standard connection ISO 228/1; in order to improve hydraulic seal has decided to create its own internal regulations, based on a soft conical thread. Therefore it is noted that to ensure the hydraulic seal declared
Material:	Polypropylene (PP)
Color:	Black (RAL 9011)
Operating pressure:	10 bar at 20°C
Max working temperature:	80°C

Torques

Filettature - Threads - Filetts	1/4"	3/8"	1/2"	3/4"	1"	1"1/4	1"1/2	2"
Serraggio Max materiale PP - Max Tightening PP material - Serrage Max Matériel PP	2 Nm	3 Nm	6 Nm	8 Nm	10 Nm	15 Nm	20 Nm	25 Nm
Serraggio Max materiale PA - Max Tightening PA material - Serrage Max Matériel PA	3 Nm	5 Nm	8 Nm	10 Nm	12 Nm	17 Nm	30 Nm	35 Nm

The maximum tightening torques specified for fittings Bucchi depend on the compliance of the threads that reference to international specifications on the threads.

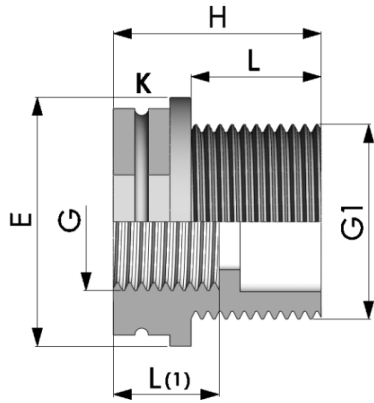

REDUCING BUSH with male threaded end G1 and reducing female threaded end Gand a female threaded end G

4000 - Outdoor & Gardening

Dimensions

Code	G1	G	L	L(1)	H	E	K
0400234.050503	3/4"	1/2"	18	17	33	31	27
0400234.050703	1"	1/2"	19,5	17	35	41	36
0400234.050705	1"	3/4"	19,5	19	35	41	36
0400234.050903	1"1/4	1/2"	21	15	39	49,5	46
0400234.050905	1"1/4	3/4"	21	16	39	49,5	46
0400234.050907	1"1/4	1"	21	19	39	49,5	46
0400234.051105	1"1/2	3/4"	21	16	39	54	50
0400234.051107	1"1/2	1"	21	19	39	54	50
0400234.051109	1"1/2	1"1/4	21	21	39	54	50
0400234.051507	2"	1"	25,5	19	43,5	69	65
0400234.051509	2"	1"1/4	25,5	21	43,5	69	65
0400234.051511	2"	1"1/2	25,5	21	43,5	69	65