

NIPPLE

Fittings with GAS threading Fittings



MODEL CODE: 0400210

TECHNICAL DATA SHEET

Connectivity standard:

External thread GAS cylindrical ISO 228/1
 Bucchi srl for pipe fittings adopts as standard connection ISO 228/1; in order to improve hydraulic seal has decided to create its own internal regulations, based on a soft conical thread. Therefore it is noted that to ensure the hydraulic seal declared

Material:

Polypropylene (PP)

Color:

Black (RAL 9011)

Operating pressure:

10 bar at 20°C
 6 bar at 20°C

Torques

Filettature - Threads - Filets	1/4"	3/8"	1/2"	3/4"	1"	1"1/4	1"1/2	2"
Serraggio Max materiale PP - Max Tightening PP material - Serrage Max Matériel PP	2 Nm	3 Nm	6 Nm	8 Nm	10 Nm	15 Nm	20 Nm	25 Nm
Serraggio Max materiale PA - Max Tightening PA material - Serrage Max Matériel PA	3 Nm	5 Nm	8 Nm	10 Nm	12 Nm	17 Nm	30 Nm	35 Nm

The maximum tightening torques specified for fittings Bucchi depend on the compliance of the threads that reference to international specifications on the threads.

NIPPLE with male threaded ends G1

4000 - Outdoor & Gardening

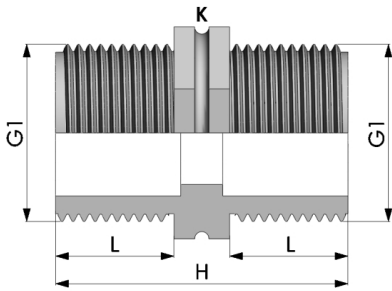

Dimensions

Code	G1	L	H	K
0400210.050303	1/2"	15,5	38	24
0400210.050505	3/4"	16	39	30
0400210.050707	1"	18,5	45	36
0400210.050909	1"1/4	20	57,5	46
0400210.051111	1"1/2	20	57,5	54
0400210.051515	2"	24	65,5	64
0400210.051919	2"1/2	32	81	80
0400210.052323	3"	39,5	95	92